

# SCSL Digital Collections

## Qualified Products List 60 - 2018

Item Type	Text
Publisher	South Carolina State Library
Rights	Copyright status undetermined. For more information contact, South Carolina State Library, 1500 Senate Street, Columbia, South Carolina 29201.
Download date	2024-09-21 00:15:20
Link to Item	<a href="http://hdl.handle.net/10827/31369">http://hdl.handle.net/10827/31369</a>

## SOUTH CAROLINA DEPARTMENT OF TRANSPORTATION

### Qualified Suppliers of Reinforcing Steel

These Producers are qualified in accordance with SCDOT Qualified Product Policy 60. Trade names are registered trademarks of the appropriate company.

SCDOT PRODUCER CODE	Producer	Contact /Telephone
SteelRebarCo005 (CMCCSC)	CMC Steel South Carolina 310 New State Road Cayce, SC 29033	Richard Ray (803) 936-3901 <a href="mailto:richard.ray@cmc.com">richard.ray@cmc.com</a>
SteelRebarCo002 (CMCJFL)	CMC Steel Florida 16770 Rebar Road Jacksonville, FL 32234	Alex Renosto (904) 266-1468 <a href="mailto:alexander.renosto@cmc.com">alexander.renosto@cmc.com</a>
SteelRebarCo003 (CMCKTN)	CMC Steel Tennessee 1919 Tennessee Avenue Knoxville, TN 37921	Jim Hall (865) 202-5972 <a href="mailto:James.Hall@cmc.com">James.Hall@cmc.com</a>
SteelRebarCo017 (CMCSNJ)	CMC Steel New Jersey 1 North Crossman Road Sayreville, NJ 08872	Joe Homic (800) 721-8047 <a href="mailto:Joseph.Homic@cmc.com">Joseph.Homic@cmc.com</a>
SteelRebarCo022 (CMCSTX)	CMC Steel Texas 1 Steel Mill Drive Seguin, Texas 78155	Jason Dinscore (830) 372-8746 <a href="mailto:Jason.dinscore@cmc.com">Jason.dinscore@cmc.com</a>
SteelRebarCo023 (CMCRCCA)	CMC Steel California 12459-B Arrow Road Rancho Cucamonga, CA 91739	Michael Mayer (909) 646-7886 <a href="mailto:Michael.Mayer@cmc.com">Michael.Mayer@cmc.com</a>
SteelRebarCo021 (EVRAZCO)	Evrax Rocky Mountain Steel 2100 South Freeway Pueblo, CO 81004	Billy Byrd (719) 561-6426 <a href="mailto:Billy.byrd@evrazna.com">Billy.byrd@evrazna.com</a>
SteelRebarCo010 (GABTX)	Gerdau Ameristeel (Beaumont Mill) 100 Old Highway 90 West Vidor, TX 77662	Leonardo Radicchi (409) 769-1086 <a href="mailto:Leonardo.cunha@gerdau.com">Leonardo.cunha@gerdau.com</a>
SteelRebarCo026 (GASPMN)	Gerdau Ameristeel (St. Paul Mill) 1678 Red Rock Road St. Paul, MN 55119	Alea Brandenburg (651) 731-5562 <a href="mailto:alea.brandenburg@gerdau.com">alea.brandenburg@gerdau.com</a>
SteelRebarCo019 (KSPIL)	Keystone Steel & Wire 7000 S.W. Adams Street Peoria, IL 61641-0002	Scott-Diestelkamp (309) 697-7543 <a href="mailto:diestesc@keystonesteel.com">diestesc@keystonesteel.com</a>
SteelRebarCo024 (NSANY)	Nucor Steel (Auburn) 25 Quarry Road Auburn, NY 13021	Rachel Palmer (315) 258-4207 <a href="mailto:Rachel.Palmer@nucor.com">Rachel.Palmer@nucor.com</a>
SteelRebarCo013 (NSBAL)	Nucor Steel (Alabama) 2301 F.L. Shuttlesworth Drive Birmingham, AL 35234	George Miljus (205) 250-7417 <a href="mailto:george.miljus@nucor.com">george.miljus@nucor.com</a>
SteelRebarCo014 (NSBIL)	Nucor Steel (Illinois) 1 Nucor Way Bourbonnais, IL 60914	Jason Rivera (815) 929-3524 <a href="mailto:Jason.rivera@nucor.com">Jason.rivera@nucor.com</a>
SteelRebarCo007 (NSDSC)	Nucor Steel (South Carolina) 300 Steel Mill Road Darlington, SC 29540	James Blew (843) 395-8658 <a href="mailto:Jim.blew@nucor.com">Jim.blew@nucor.com</a>
SteelRebarCo016 (NSKAZ)	Nucor Steel (Arizona) 3000 West Old Highway 66 Kingman, AZ 86413	Vijay M. Choksi (928) 718-7035 Ext. 217 <a href="mailto:Vijay.Choksi@nucor.com">Vijay.Choksi@nucor.com</a>







SteelRebarCo025 (NSMOH)	Nucor Steel (Ohio) 912 Cheney Avenue Marion, OH 43302	Justin Spitzer (704) 383-9651 <a href="mailto:Justin.spitzer@nucor.com">Justin.spitzer@nucor.com</a>
SteelRebarCo027 (NSPUT)	Nucor Steel (Utah) 7285 W 2100 N West Cemetery Road Plymouth, UT 84330	Brenda Porath (435) 458-9208 <a href="mailto:brenda.porath@nucor.com">brenda.porath@nucor.com</a>
SteelRebarCo008 (NSSWA)	Nucor Steel (Washington) 2424 SW Andover Street Seattle, Washington 98106	Erik Nissen (206) 724-4727 <a href="mailto:Erik.Nissen@Nucor.com">Erik.Nissen@Nucor.com</a>
SteelRebarCo012 (NSWCT)	Nucor Steel (Connecticut) 35 Toelles Road. Wallingford, CT 06492	John Brasell (203) 949-6848 <a href="mailto:John.brasell@nucor.com">John.brasell@nucor.com</a>
SteelRebarCo028 (SDIPIN)	Steel Dynamics Inc. 8000 N County Road 225 E Pittsboro, IN 46167	Brandon Dugan (317) 892-7166 <a href="mailto:Brandon.Dugan2@steeldynamics.com">Brandon.Dugan2@steeldynamics.com</a>

---

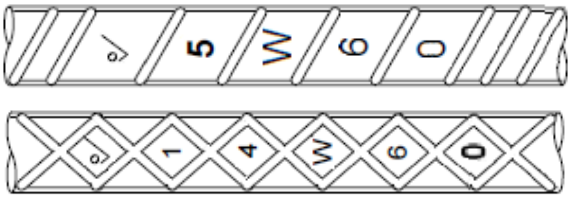
SCDOT contact person for this Qualified Product List:

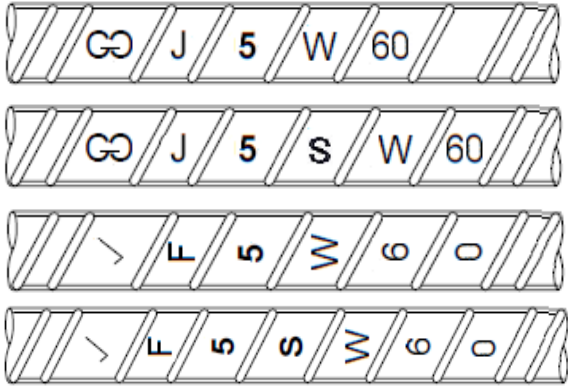
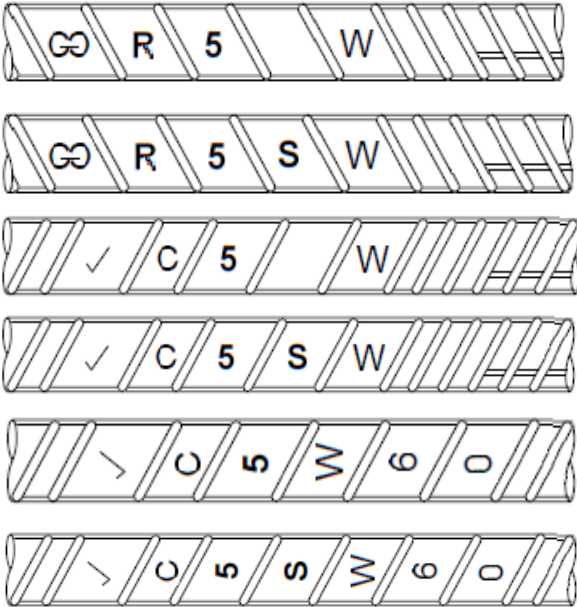
Caleb Gunter, PE  
Structural Steel Engineer  
SCDOT Office of Materials and Research  
1406 Shop Road  
Columbia, SC 29201  
Telephone: (803) 737-6694  
Fax: (803) 737-6649  
E-mail: [guntercb@scdot.org](mailto:guntercb@scdot.org)

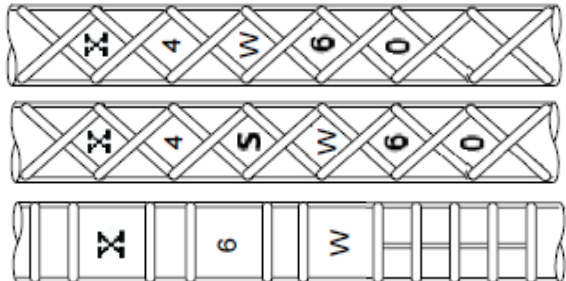
### Current Acceptable Rebar Mill Markings

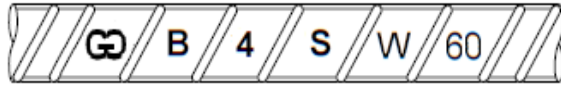
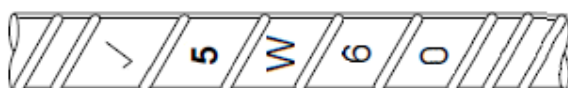
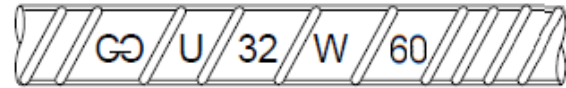
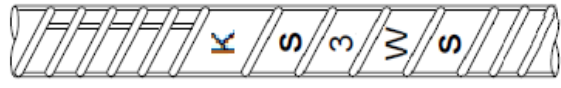
<p>CMC Steel - Cayce, South Carolina [CMCCSC]</p> 	<p>CMC Steel - Seguin, Texas [CMCSTX] (Continued)</p> 
<p>CMC Steel - Jacksonville, Florida [CMCJFL]</p> 	<p>CMC Steel - Ranco Cucamonga, California [CMCRCA]</p> 
<p>CMC Steel - Knoxville, Tennessee [CMCKTN]</p> 	<p>Evraz Rocky Mountain Steel - Pueblo, Colorado [EVRAZCO]</p> 
<p>CMC Steel - Sayreville, New Jersey [CMCSNJ]</p> 	<p>Gerdau Ameristeel - Beaumont, Texas [GABTX]</p> 
<p>CMC Steel - Seguin, Texas [CMCSTX]</p> 	<p>Gerdau Ameristeel - St. Paul, Minnesota [GASPMN]</p>  <p>Keystone Steel &amp; Wire Co. - Peoria, Illinois [KSPIL]</p> 

Nucor Steel - Auburn, New York [NSANY]



Nucor Steel Birmingham - Birmingham, Alabama [NSBAL]

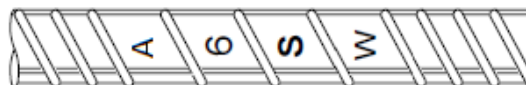
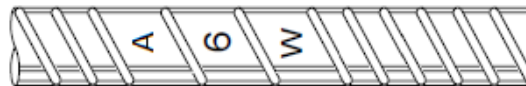
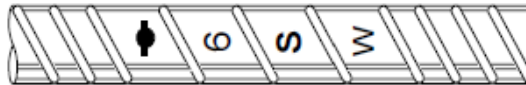
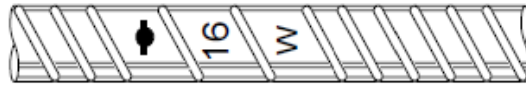

Nucor Steel Kankakee - Bourbonnais, IL [NSBIL]

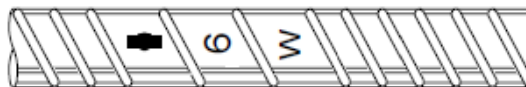

Nucor Steel - Darlington, South Carolina [NSDSC]

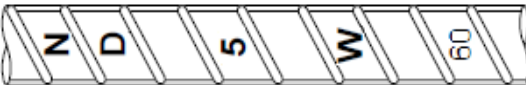

Nucor Steel Kingman - Kingman, Arizona [NSKAZ]

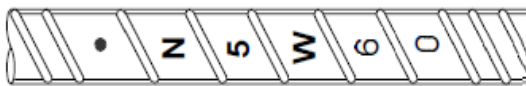

Nucor Steel - Marion, Ohio [NSMOH]

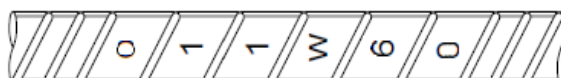
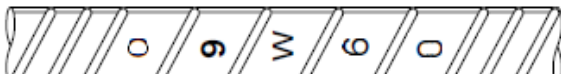
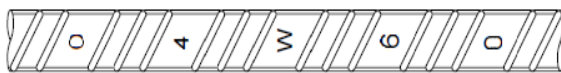

Nucor Steel - Plymouth, Utah [NSPUT]

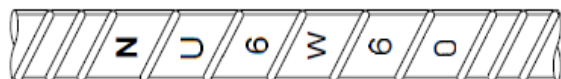

Nucor Steel - Plymouth, Utah [NSPUT] (Continued)

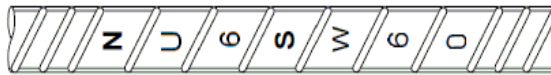
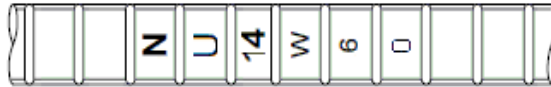

Nucor Steel - Seattle Washington [NSSWA]

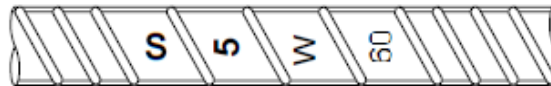

Nucor Steel - Wallingford, Connecticut [NSWCT]

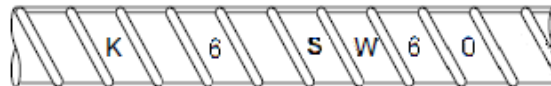

Steel Dynamics, Inc. - Pittsboro, Indiana [SDIPIN]

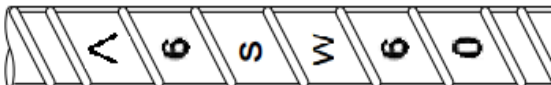

Notes

1. Rebar Mill markings must include the following (in this order):
  - a. Unique manufacturer identification symbol
  - b. Size designation
    - i. Can be metric or standard sizes
  - c. Symbol showing the type of steel
  - d. A minimum yield designation number
    - i. The number 4 for Grade 420 (420 mPa)
    - ii. The number 60 for Grade 60 steel (60 ksi)
    - iii. If no grade number is given, there should be a grade line covering at least 5 deformations in addition to the main rib. One line indicates Grade 60 (Grade 420)
2. All steel must be ASTM A 706 (designated by a “W” or “SW”)
3. All steel must be grade 60 (Grade 420).
4. Mill markings from producers can change.
5. New marking must :
  - a. Come from an approved source
  - b. Show bar size
  - c. Show “W” or “SW” for ASTM A -706 steel
  - d. Indicate Grade 60 (Grade 420)

